

BAR LIGHTS LL120 AND LL60

Direct, universal illumination of most surfaces. Allows the use of Dark and Bright Field light sources depending on the distance and angle towards the scanned object.

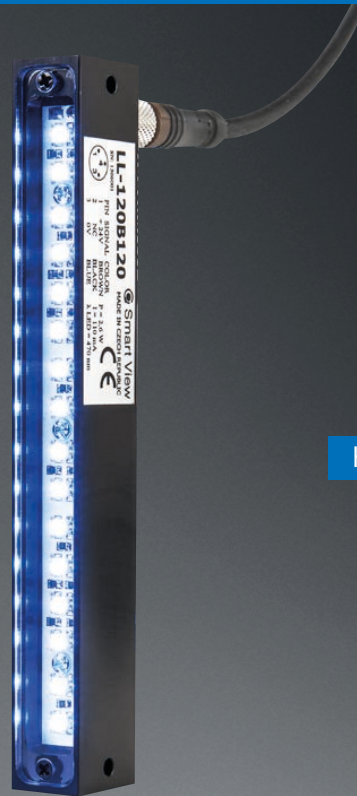

- COMPACT DESIGN
- HOMOGENOUS LIGHT FIELD
- UNIVERSAL MOUNTING
- ROUGH, METAL HOUSING

CONFIGURATION

Ordering Code

LL -	60	R	60
Linear Light	light length	wavelength	LED radiation angle

LL-60

model series	active illumination area	wavelength	LED radiation angle
LL-60W120	60 × 12 mm	white	120°
LL-60B120	60 × 12 mm	470 nm	120°
LL-60G120	60 × 12 mm	525 nm	120°
LL-60R60	60 × 12 mm	633 nm	60°
LL-60IR50	60 × 12 mm	850 nm	50°

LL-120

model	active illumination area	wavelength	LED radiation angle
LL-120W120	120 × 12 mm	white	120°
LL-120B120	120 × 12 mm	470 nm	120°
LL-120G120	120 × 12 mm	525 nm	120°
LL-120R60	120 × 12 mm	633 nm	60°
LL-120IR50	120 × 12 mm	850 nm	50°

WAYS OF USE

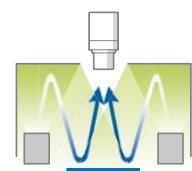
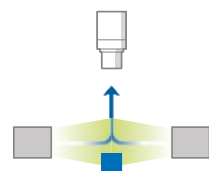
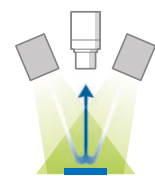
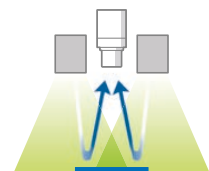

BASIC ELECTRIC PARAMETERS

Model		LL-60W120	LL-60B120	LL-60G120	LL-60R60	LL-60IR50
Voltage Span	U_n	18-28 V	18-28 V	22-28 V	20-28 V	22-26 V
Nominal Voltage	U_{jm}	24 V	24 V	24 V	24 V	24 V
Nominal Current	I_{jm}	60 mA	60 mA	100 mA	40mA	60 mA
Max. Current	I_{max}	65 mA	60 mA	110 mA	40mA	90 mA
Trigger Voltage	U_{trig}	N/A	N/A	N/A	N/A	N/A
Trigger Current	I_{trig}	N/A	N/A	N/A	N/A	N/A
Input	P	1,5 W	1,5 W	2,4 W	1 W	1,5 W

Model		LL-120W120	LL-120B120	LL-120G120	LL-120R60	LL-120IR50
Voltage Span	U_n	23-28 V	22-28 V	22-28 V	22-28 V	22-28 V
Nominal Voltage	U_{jm}	24 V	24 V	24 V	24 V	24 V
Nominal Current	I_{jm}	133 mA	150 mA	115 mA	90 mA	150 mA
Max. Current	I_{max}	150 mA	160 mA	150 mA	125 mA	160 mA
Trigger Voltage	U_{trig}	N/A	N/A	N/A	N/A	N/A
Trigger Current	I_{trig}	N/A	N/A	N/A	N/A	N/A
Input	P	3,5 W	3,6 W	2,8 W	2 W	3,6 W

DIMENSIONS AND WEIGHT

Model	A length (mm)	B width (mm)	C height (mm)	Active lighting area	Weight
LL-60...	74	15	20	60 × 12 mm	43 g
LL-120...	134	15	20	120 × 12 mm	75 g

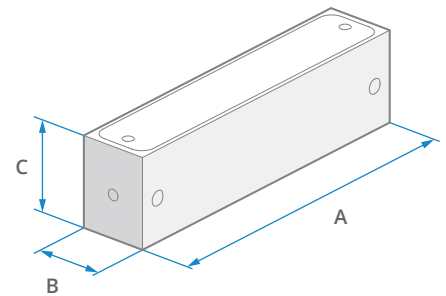

CONTROLLER CM-01

Universal illumination intensity controller
Trigger signal input

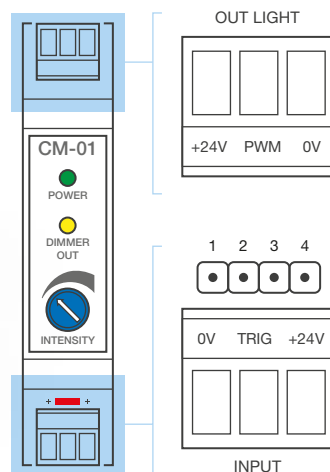

TERMINAL BOX OUTPUT "OUT LIGHT" – LIGHT CONNECTION

Terminal +24 V light positive pole
Terminal PWM PWM signal
Terminal 0 V light negative pole

TERMINAL BOX INPUT "INPUT" – POWER SUPPLY AND CONTROL SIGNAL CONNECTION

Terminal +24 V positive pole of 24 V DC Power Supply
Terminal 0 V negative pole of 24 V DC Power Supply
Terminal TRIG trigger signal from camera, PLC, etc.

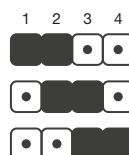

CM-01 MODE OPTION

1 - 2 Enable – constant light
2 - 3 Not used
1 - 2 Invert trig – light during log 0 signal

OVERALL BASIC INFORMATION

Technical data

IP category	IP50
Protection Category	III
Ambient temperature	-20 - +40 °C
Isolation resistance	500 V
Housing material	Duralumin

CONNECTOR PIN ASSIGNMENT

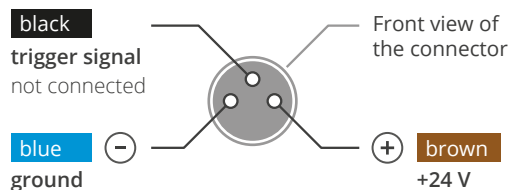

ACCESSORIES INCLUDED

Transparent diffuser, diffuser with the opacity of 68 %, 5 m straight cable



clear



68%

OPTIONAL ACCESSORIES

Diffusers with the opacity of 38 % and 50 %, polarized diffuser, 5 m angular cable



38%



50%



Company Office

Smart View s.r.o.
Nivy 313
765 02 Otrokovice
Czech Republic
+420 601 575 797
+420 602 457 497
info@smartview.cz
www.smartview.cz

International Sales Slovakia

MTS, spol. s r.o.
Krivá 53
027 55 Krivá
Slovakia
+421 43 5819 111
mts@mts.sk
www.mts.sk